

MOTEK 2010

PI 053/10
07/15/2010

EcoShape Tubular Framing System from Rexroth: Easy-to-Configure, Flexible System with MTpro Planning Software

- ▶ Flexible combination of rectangular and round profiles
- ▶ Save time and money with planning software
- ▶ Simple planning without a CAD system

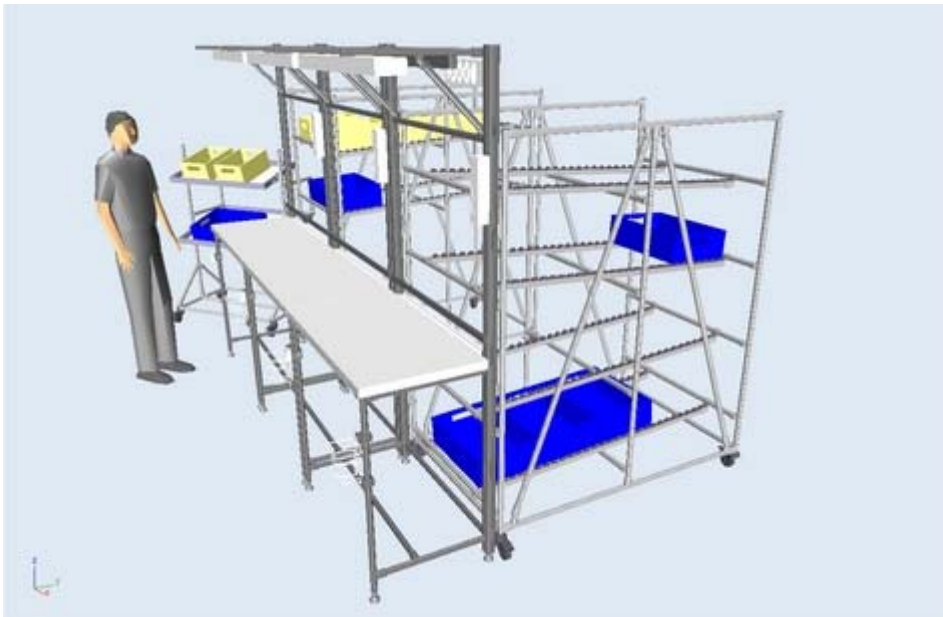

Users can easily combine square and rectangular strut profiles with the EcoShape tubular framing system from Rexroth. The MTpro planning software is available for quick and reliable planning.

The EcoShape tubular framing system from Rexroth offers users high flexibility when assembling workstations, material shuttles, or racks. Square and rectangular strut profiles and components from the modular Manual Production Systems (MPS) result in individual and versatile solutions. EcoShape only consists of 14 individual components and ensures high stability thanks to its optimized profile and connector geometry.

When compared to steel, the components made from aluminum are more than 30 percent lighter, completely reusable and recyclable. Users can expand existing solutions, or create new ones, from existing constructions in a short amount of time and avoid waste, in accordance with lean production. The tubular framing system allows the step-by-step optimization of current and future tasks in production – in line with the kaizen principle.

Contact for Journalists:
Bosch Rexroth AG
Ingrid Alter
P.O. Box 30 02 07
D-70442 Stuttgart
Tel.: +49 711 811-46181
Fax: +49 711 811-31543
ingrid.alter@boschrexroth.de

Press Release

Users save a lot of time when laying out the system with the MTpro planning software from Rexroth. By using drag-and-drop, components and modules can be pulled out of the product catalog and put into a virtual 3-D environment; they automatically snap into the correct mounting position. This allows complete frames, racks, and workplace systems to be created in no time at all. MTpro works in the background to calculate the order list with all necessary components and accessories. With another click of the mouse, these can be added to the shopping cart and ordered directly in the Rexroth eShop. It is possible to take over the created models into your own designs in every common CAD system.

PI 053/10
07/15/2010

A test version of the MTpro planning software is available at no charge at: www.boschrexroth.com/mtpro.

Rexroth will be at the Motek in hall 3, stand 3305.

Bosch Rexroth AG is one of the world's leading specialists in the field of drive and control technologies. Under the brand name of Rexroth, the company supplies more than 500,000 customers with tailored solutions for driving, controlling, and moving. Bosch Rexroth is a partner for industrial applications and factory automation, mobile applications, and using renewable energies. As The Drive & Control Company, Bosch Rexroth develops, produces and sells components and systems in more than 80 countries. In 2009, Bosch Rexroth, part of the Bosch Group, achieved sales of around 4.1 billion Euro with 34,200 employees.

For more information please visit: www.boschrexroth.com

Reader Inquiries:

Tel.: +49 711 811-46181
Fax: +49 711 811-31543
E-mail: ingrid.alter@boschrexroth.de
Address: P.O. Box 30 02 07, D-70442 Stuttgart
Internet: www.boschrexroth.com/mtpro

Contact for Journalists:
Bosch Rexroth AG
Ingrid Alter
P.O. Box 30 02 07
D-70442 Stuttgart
Tel.: +49 711 811-46181
Fax: +49 711 811-31543
ingrid.alter@boschrexroth.de